

# Introduction

- Effective safety and health programs
- Hazard Identification
- Emphasis Programs
  
- Questions any time



# OSHA's Mission

**Assure so far as possible safe and healthful working conditions for every working man and woman in the nation.**



# I2P2 - Effective Safety & Health Programs

- Management Commitment
- Employee Involvement.
- Worksite Analysis
- Hazard Prevention and Controls.
- Training and Understanding
- Continuous Improvement

# OSHA must prove

- Exposed employee
- Serious hazard
- Employer knowledge
- Feasible method to abate hazard

# Do you have a truly effective safety and health program?

- Do you have clear rules and expectations?
- How do you know employees understand the rules and expectations?
- Do you have an effective process to discover deviations from expectations?
- Do you have an effective enforcement program?

# Penalty

- Severity of the hazard
- Probability

# Repeat Violations

Proposed if a final order  
citation has been affirmed  
in the previous 5 yrs

# Severe Violators Enforcement Program

## Four CATEGORIES of SVEP!

1. **FATCAT:**  $\geq 1$  W, R, FTA related to the incident
2. **High Emphasis Hazard:**  $\geq 2$  W, R, or FTA related to HE hazards
3. **Potential Release of Highly Hazardous Chemical:**  $> 3$  W, R, or FTA related to hazards of the chemical release
4. **All Egregious cases**

# Focus on the six major hazards:

- Falls
- Electrocution
- Engulfment
- Auger entanglement
- Combustible dust explosions
- Struck by

# Appropriate traffic control

- Temporary traffic control in accordance with MUTCD or IDOT.
  - Advance warning signs
  - Channeling devices

IDOT Plan

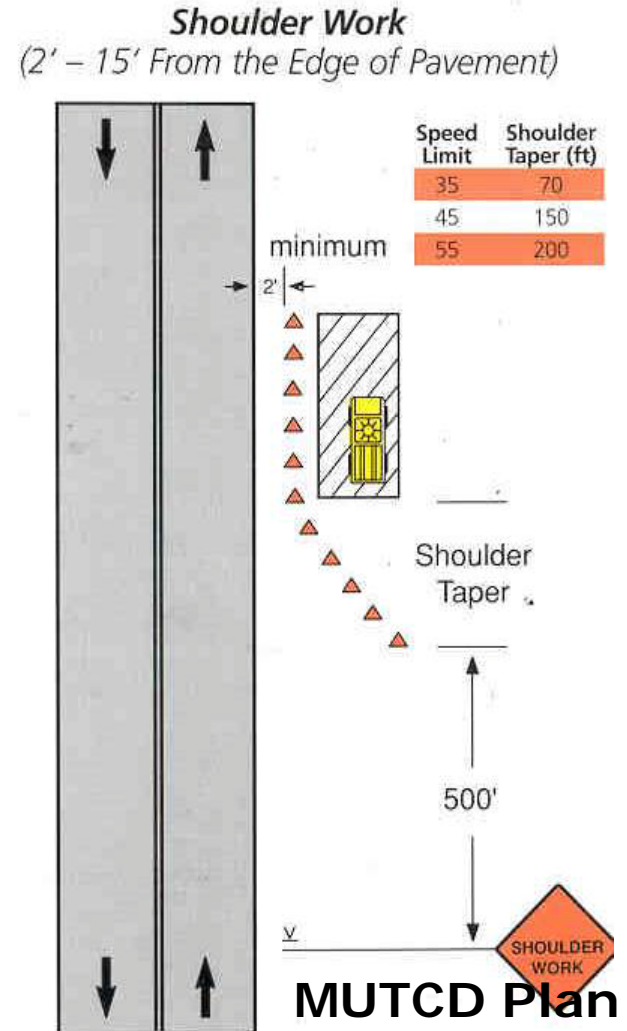

# Looking for hazards

- Inspector at site
- No quota
- Simply do the job

# Inspectors must address...

- personnel protective equipment
- grain entry program and procedures (272)
- confined space entry program (146)
- housekeeping programs
- fork lift operation
- lock-out/tag-out program
- Safety Related Work Practices
- fall protection program
- machine guarding (amputation hazards)

# Log of Work-Related Injuries and Illnesses

**Attention:** This form contains information relating to employee health and must be used in a manner that protects the confidentiality of employees to the extent possible while the information is being used for occupational safety and health purposes.

Year 20\_\_



U.S. Department of Labor  
Occupational Safety and Health Administration

You must record information about every work-related death and about every work-related injury or illness that involves loss of consciousness, restricted work activity or job transfer, days away from work, or medical treatment beyond first aid. You must also record significant work-related injuries and illnesses that are diagnosed by a physician or licensed health care professional. You must also record work-related injuries and illnesses that meet any of the specific recording criteria listed in 29 CFR Part 1904.6 through 1904.12. Feel free to use two lines for a single case if you need to. You must complete an Injury and Illness Incident Report (OSHA Form 301) or equivalent form for each injury or illness recorded on this form. If you're not sure whether a case is recordable, call your local OSHA office for help.

Establishment name \_\_\_\_\_

City \_\_\_\_\_ Date \_\_\_\_\_

Identify the person			Describe the case			Classify the case				Enter the number of days the injured or ill worker was:		Check the "Injury" column or choose one type of illness:						
(A) Case no.	(B) Employee's name	(C) Job title (e.g., Welder)	(D) Date of injury or onset of illness	(E) Where the event occurred (e.g., Loading dock work end)	(F) Describe injury or illness, parts of body affected, and object/substance that directly injured or made person ill (e.g., Second degree burn on right forearm from acetylene torch)	CHECK ONLY ONE box for each case based on the most serious outcome for that case:				Away from work (K) / On job transfer or restriction (L)		Check the "Injury" column or choose one type of illness:						
						Remained at Work												
						Death (G)	Days away from work (H)	Job transfer or restriction (I)	Other recordable cases (J)									
						<input type="checkbox"/>	<input type="checkbox"/>	<input type="checkbox"/>	<input type="checkbox"/>	(K)	(L)	(1)	(2)	(3)	(4)	(5)	(6)	
			month/day			<input type="checkbox"/>	<input type="checkbox"/>	<input type="checkbox"/>	<input type="checkbox"/>			<input type="checkbox"/>	<input type="checkbox"/>	<input type="checkbox"/>	<input type="checkbox"/>	<input type="checkbox"/>	<input type="checkbox"/>	<input type="checkbox"/>
			month/day			<input type="checkbox"/>	<input type="checkbox"/>	<input type="checkbox"/>	<input type="checkbox"/>			<input type="checkbox"/>	<input type="checkbox"/>	<input type="checkbox"/>	<input type="checkbox"/>	<input type="checkbox"/>	<input type="checkbox"/>	<input type="checkbox"/>
			month/day			<input type="checkbox"/>	<input type="checkbox"/>	<input type="checkbox"/>	<input type="checkbox"/>			<input type="checkbox"/>	<input type="checkbox"/>	<input type="checkbox"/>	<input type="checkbox"/>	<input type="checkbox"/>	<input type="checkbox"/>	<input type="checkbox"/>
			month/day			<input type="checkbox"/>	<input type="checkbox"/>	<input type="checkbox"/>	<input type="checkbox"/>			<input type="checkbox"/>	<input type="checkbox"/>	<input type="checkbox"/>	<input type="checkbox"/>	<input type="checkbox"/>	<input type="checkbox"/>	<input type="checkbox"/>
			month/day			<input type="checkbox"/>	<input type="checkbox"/>	<input type="checkbox"/>	<input type="checkbox"/>			<input type="checkbox"/>	<input type="checkbox"/>	<input type="checkbox"/>	<input type="checkbox"/>	<input type="checkbox"/>	<input type="checkbox"/>	<input type="checkbox"/>
			month/day			<input type="checkbox"/>	<input type="checkbox"/>	<input type="checkbox"/>	<input type="checkbox"/>			<input type="checkbox"/>	<input type="checkbox"/>	<input type="checkbox"/>	<input type="checkbox"/>	<input type="checkbox"/>	<input type="checkbox"/>	<input type="checkbox"/>
			month/day			<input type="checkbox"/>	<input type="checkbox"/>	<input type="checkbox"/>	<input type="checkbox"/>			<input type="checkbox"/>	<input type="checkbox"/>	<input type="checkbox"/>	<input type="checkbox"/>	<input type="checkbox"/>	<input type="checkbox"/>	<input type="checkbox"/>
			month/day			<input type="checkbox"/>	<input type="checkbox"/>	<input type="checkbox"/>	<input type="checkbox"/>			<input type="checkbox"/>	<input type="checkbox"/>	<input type="checkbox"/>	<input type="checkbox"/>	<input type="checkbox"/>	<input type="checkbox"/>	<input type="checkbox"/>
			month/day			<input type="checkbox"/>	<input type="checkbox"/>	<input type="checkbox"/>	<input type="checkbox"/>			<input type="checkbox"/>	<input type="checkbox"/>	<input type="checkbox"/>	<input type="checkbox"/>	<input type="checkbox"/>	<input type="checkbox"/>	<input type="checkbox"/>
			month/day			<input type="checkbox"/>	<input type="checkbox"/>	<input type="checkbox"/>	<input type="checkbox"/>			<input type="checkbox"/>	<input type="checkbox"/>	<input type="checkbox"/>	<input type="checkbox"/>	<input type="checkbox"/>	<input type="checkbox"/>	<input type="checkbox"/>
			month/day			<input type="checkbox"/>	<input type="checkbox"/>	<input type="checkbox"/>	<input type="checkbox"/>			<input type="checkbox"/>	<input type="checkbox"/>	<input type="checkbox"/>	<input type="checkbox"/>	<input type="checkbox"/>	<input type="checkbox"/>	<input type="checkbox"/>
			month/day			<input type="checkbox"/>	<input type="checkbox"/>	<input type="checkbox"/>	<input type="checkbox"/>			<input type="checkbox"/>	<input type="checkbox"/>	<input type="checkbox"/>	<input type="checkbox"/>	<input type="checkbox"/>	<input type="checkbox"/>	<input type="checkbox"/>
			month/day			<input type="checkbox"/>	<input type="checkbox"/>	<input type="checkbox"/>	<input type="checkbox"/>			<input type="checkbox"/>	<input type="checkbox"/>	<input type="checkbox"/>	<input type="checkbox"/>	<input type="checkbox"/>	<input type="checkbox"/>	<input type="checkbox"/>
			month/day			<input type="checkbox"/>	<input type="checkbox"/>	<input type="checkbox"/>	<input type="checkbox"/>			<input type="checkbox"/>	<input type="checkbox"/>	<input type="checkbox"/>	<input type="checkbox"/>	<input type="checkbox"/>	<input type="checkbox"/>	<input type="checkbox"/>
			month/day			<input type="checkbox"/>	<input type="checkbox"/>	<input type="checkbox"/>	<input type="checkbox"/>			<input type="checkbox"/>	<input type="checkbox"/>	<input type="checkbox"/>	<input type="checkbox"/>	<input type="checkbox"/>	<input type="checkbox"/>	<input type="checkbox"/>
			month/day			<input type="checkbox"/>	<input type="checkbox"/>	<input type="checkbox"/>	<input type="checkbox"/>			<input type="checkbox"/>	<input type="checkbox"/>	<input type="checkbox"/>	<input type="checkbox"/>	<input type="checkbox"/>	<input type="checkbox"/>	<input type="checkbox"/>
			month/day			<input type="checkbox"/>	<input type="checkbox"/>	<input type="checkbox"/>	<input type="checkbox"/>			<input type="checkbox"/>	<input type="checkbox"/>	<input type="checkbox"/>	<input type="checkbox"/>	<input type="checkbox"/>	<input type="checkbox"/>	<input type="checkbox"/>
			month/day			<input type="checkbox"/>	<input type="checkbox"/>	<input type="checkbox"/>	<input type="checkbox"/>			<input type="checkbox"/>	<input type="checkbox"/>	<input type="checkbox"/>	<input type="checkbox"/>	<input type="checkbox"/>	<input type="checkbox"/>	<input type="checkbox"/>
			month/day			<input type="checkbox"/>	<input type="checkbox"/>	<input type="checkbox"/>	<input type="checkbox"/>			<input type="checkbox"/>	<input type="checkbox"/>	<input type="checkbox"/>	<input type="checkbox"/>	<input type="checkbox"/>	<input type="checkbox"/>	<input type="checkbox"/>
			month/day			<input type="checkbox"/>	<input type="checkbox"/>	<input type="checkbox"/>	<input type="checkbox"/>			<input type="checkbox"/>	<input type="checkbox"/>	<input type="checkbox"/>	<input type="checkbox"/>	<input type="checkbox"/>	<input type="checkbox"/>	<input type="checkbox"/>
			month/day			<input type="checkbox"/>	<input type="checkbox"/>	<input type="checkbox"/>	<input type="checkbox"/>			<input type="checkbox"/>	<input type="checkbox"/>	<input type="checkbox"/>	<input type="checkbox"/>	<input type="checkbox"/>	<input type="checkbox"/>	<input type="checkbox"/>
			month/day			<input type="checkbox"/>	<input type="checkbox"/>	<input type="checkbox"/>	<input type="checkbox"/>			<input type="checkbox"/>	<input type="checkbox"/>	<input type="checkbox"/>	<input type="checkbox"/>	<input type="checkbox"/>	<input type="checkbox"/>	<input type="checkbox"/>
			month/day			<input type="checkbox"/>	<input type="checkbox"/>	<input type="checkbox"/>	<input type="checkbox"/>			<input type="checkbox"/>	<input type="checkbox"/>	<input type="checkbox"/>	<input type="checkbox"/>	<input type="checkbox"/>	<input type="checkbox"/>	<input type="checkbox"/>
			month/day			<input type="checkbox"/>	<input type="checkbox"/>	<input type="checkbox"/>	<input type="checkbox"/>			<input type="checkbox"/>	<input type="checkbox"/>	<input type="checkbox"/>	<input type="checkbox"/>	<input type="checkbox"/>	<input type="checkbox"/>	<input type="checkbox"/>
			month/day			<input type="checkbox"/>	<input type="checkbox"/>	<input type="checkbox"/>	<input type="checkbox"/>			<input type="checkbox"/>	<input type="checkbox"/>	<input type="checkbox"/>	<input type="checkbox"/>	<input type="checkbox"/>	<input type="checkbox"/>	<input type="checkbox"/>
			month/day			<input type="checkbox"/>	<input type="checkbox"/>	<input type="checkbox"/>	<input type="checkbox"/>			<input type="checkbox"/>	<input type="checkbox"/>	<input type="checkbox"/>	<input type="checkbox"/>	<input type="checkbox"/>	<input type="checkbox"/>	<input type="checkbox"/>
			month/day			<input type="checkbox"/>	<input type="checkbox"/>	<input type="checkbox"/>	<input type="checkbox"/>			<input type="checkbox"/>	<input type="checkbox"/>	<input type="checkbox"/>	<input type="checkbox"/>	<input type="checkbox"/>	<input type="checkbox"/>	<input type="checkbox"/>
			month/day			<input type="checkbox"/>	<input type="checkbox"/>	<input type="checkbox"/>	<input type="checkbox"/>			<input type="checkbox"/>	<input type="checkbox"/>	<input type="checkbox"/>	<input type="checkbox"/>	<input type="checkbox"/>	<input type="checkbox"/>	<input type="checkbox"/>
			month/day			<input type="checkbox"/>	<input type="checkbox"/>	<input type="checkbox"/>	<input type="checkbox"/>			<input type="checkbox"/>	<input type="checkbox"/>	<input type="checkbox"/>	<input type="checkbox"/>	<input type="checkbox"/>	<input type="checkbox"/>	<input type="checkbox"/>
			month/day			<input type="checkbox"/>	<input type="checkbox"/>	<input type="checkbox"/>	<input type="checkbox"/>			<input type="checkbox"/>	<input type="checkbox"/>	<input type="checkbox"/>	<input type="checkbox"/>	<input type="checkbox"/>	<input type="checkbox"/>	<input type="checkbox"/>
			month/day			<input type="checkbox"/>	<input type="checkbox"/>	<input type="checkbox"/>	<input type="checkbox"/>			<input type="checkbox"/>	<input type="checkbox"/>	<input type="checkbox"/>	<input type="checkbox"/>	<input type="checkbox"/>	<input type="checkbox"/>	<input type="checkbox"/>
			month/day			<input type="checkbox"/>	<input type="checkbox"/>	<input type="checkbox"/>	<input type="checkbox"/>			<input type="checkbox"/>	<input type="checkbox"/>	<input type="checkbox"/>	<input type="checkbox"/>	<input type="checkbox"/>	<input type="checkbox"/>	<input type="checkbox"/>
			month/day			<input type="checkbox"/>	<input type="checkbox"/>	<input type="checkbox"/>	<input type="checkbox"/>			<input type="checkbox"/>	<input type="checkbox"/>	<input type="checkbox"/>	<input type="checkbox"/>	<input type="checkbox"/>	<input type="checkbox"/>	<input type="checkbox"/>
			month/day			<input type="checkbox"/>	<input type="checkbox"/>	<input type="checkbox"/>	<input type="checkbox"/>			<input type="checkbox"/>	<input type="checkbox"/>	<input type="checkbox"/>	<input type="checkbox"/>	<input type="checkbox"/>	<input type="checkbox"/>	<input type="checkbox"/>
			month/day			<input type="checkbox"/>	<input type="checkbox"/>	<input type="checkbox"/>	<input type="checkbox"/>			<input type="checkbox"/>	<input type="checkbox"/>	<input type="checkbox"/>	<input type="checkbox"/>	<input type="checkbox"/>	<input type="checkbox"/>	<input type="checkbox"/>
			month/day			<input type="checkbox"/>	<input type="checkbox"/>	<input type="checkbox"/>	<input type="checkbox"/>			<input type="checkbox"/>	<input type="checkbox"/>	<input type="checkbox"/>	<input type="checkbox"/>	<input type="checkbox"/>	<input type="checkbox"/>	<input type="checkbox"/>
			month/day			<input type="checkbox"/>	<input type="checkbox"/>	<input type="checkbox"/>	<input type="checkbox"/>			<input type="checkbox"/>	<input type="checkbox"/>	<input type="checkbox"/>	<input type="checkbox"/>	<input type="checkbox"/>	<input type="checkbox"/>	<input type="checkbox"/>
			month/day			<input type="checkbox"/>	<input type="checkbox"/>	<input type="checkbox"/>	<input type="checkbox"/>			<input type="checkbox"/>	<input type="checkbox"/>	<input type="checkbox"/>	<input type="checkbox"/>	<input type="checkbox"/>	<input type="checkbox"/>	<input type="checkbox"/>
			month/day			<input type="checkbox"/>	<input type="checkbox"/>	<input type="checkbox"/>	<input type="checkbox"/>			<input type="checkbox"/>	<input type="checkbox"/>	<input type="checkbox"/>	<input type="checkbox"/>	<input type="checkbox"/>	<input type="checkbox"/>	<input type="checkbox"/>
			month/day			<input type="checkbox"/>	<input type="checkbox"/>	<input type="checkbox"/>	<input type="checkbox"/>			<input type="checkbox"/>	<input type="checkbox"/>	<input type="checkbox"/>	<input type="checkbox"/>	<input type="checkbox"/>	<input type="checkbox"/>	<input type="checkbox"/>
			month/day			<input type="checkbox"/>	<input type="checkbox"/>	<input type="checkbox"/>	<input type="checkbox"/>			<input type="checkbox"/>	<input type="checkbox"/>	<input type="checkbox"/>	<input type="checkbox"/>	<input type="checkbox"/>	<input type="checkbox"/>	<input type="checkbox"/>
			month/day			<input type="checkbox"/>	<input type="checkbox"/>	<input type="checkbox"/>	<input type="checkbox"/>			<input type="checkbox"/>	<input type="checkbox"/>	<input type="checkbox"/>	<input type="checkbox"/>	<input type="checkbox"/>	<input type="checkbox"/>	<input type="checkbox"/>
			month/day			<input type="checkbox"/>	<input type="checkbox"/>	<input type="checkbox"/>	<input type="checkbox"/>			<input type="checkbox"/>	<input type="checkbox"/>	<input type="checkbox"/>	<input type="checkbox"/>	<input type="checkbox"/>	<input type="checkbox"/>	<input type="checkbox"/>
			month/day			<input type="checkbox"/>	<input type="checkbox"/>	<input type="checkbox"/>	<input type="checkbox"/>			<input type="checkbox"/>	<input type="checkbox"/>	<input type="checkbox"/>	<input type="checkbox"/>	<input type="checkbox"/>	<input type="checkbox"/>	<input type="checkbox"/>
			month/day			<input type="checkbox"/>	<input type="checkbox"/>	<input type="checkbox"/>	<input type="checkbox"/>			<input type="checkbox"/>	<input type="checkbox"/>	<input type="checkbox"/>	<input type="checkbox"/>	<input type="checkbox"/>	<input type="checkbox"/>	<input type="checkbox"/>
			month/day			<input type="checkbox"/>	<input type="checkbox"/>	<input type="checkbox"/>	<input type="checkbox"/>			<input type="checkbox"/>	<input type="checkbox"/>	<input type="checkbox"/>	<input type="checkbox"/>	<input type="checkbox"/>	<input type="checkbox"/>	<input type="checkbox"/>
			month/day			<input type="checkbox"/>	<input type="checkbox"/>	<input type="checkbox"/>	<input type="checkbox"/>			<input type="checkbox"/>	<input type="checkbox"/>	<input type="checkbox"/>	<input type="checkbox"/>	<input type="checkbox"/>	<input type="checkbox"/>	<input type="checkbox"/>
			month/day			<input type="checkbox"/>	<input type="checkbox"/>	<input type="checkbox"/>	<input type="checkbox"/>			<input type="checkbox"/>	<input type="checkbox"/>	<input type="checkbox"/>	<input type="checkbox"/>	<input type="checkbox"/>	<input type="checkbox"/>	<input type="checkbox"/>
			month/day			<input type="checkbox"/>	<input type="checkbox"/>	<input type="checkbox"/>	<input type="checkbox"/>			<input type="checkbox"/>	<input type="checkbox"/>	<input type="checkbox"/>	<input type="checkbox"/>	<input type="checkbox"/>	<input type="checkbox"/>	<input type="checkbox"/>
			month/day			<input type="checkbox"/>	<input type="checkbox"/>	<input type="checkbox"/>	<input type="checkbox"/>			<input type="checkbox"/>	<input type="checkbox"/>	<input type="checkbox"/>	<input type="checkbox"/>	<input type="checkbox"/>	<input type="checkbox"/>	<input type="checkbox"/>
			month/day			<input type="checkbox"/>	<input type="checkbox"/>	<input type="checkbox"/>	<input type="checkbox"/>			<input type="checkbox"/>	<input type="checkbox"/>	<input type="checkbox"/>	<input type="checkbox"/>	<input type="checkbox"/>	<input type="checkbox"/>	<input type="checkbox"/>
			month/day			<input type="checkbox"/>	<input type="checkbox"/>	<input type="checkbox"/>	<input type="checkbox"/>			<input type="checkbox"/>	<input type="checkbox"/>	<input type="checkbox"/>	<input type="checkbox"/>	<input type="checkbox"/>	<input type="checkbox"/>	<input type="checkbox"/>
			month/day			<input type="checkbox"/>	<input type="checkbox"/>	<input type="checkbox"/>	<input type="checkbox"/>			<input type="checkbox"/>	<input type="checkbox"/>	<input type="checkbox"/>	<input type="checkbox"/>	<input type="checkbox"/>	<input type="checkbox"/>	<input type="checkbox"/>
			month/day			<input type="checkbox"/>	<input type="checkbox"/>	<input type="checkbox"/>	<input type="checkbox"/>			<input type="checkbox"/>	<input type="checkbox"/>	<input type="checkbox"/>	<input type="checkbox"/>	<input type="checkbox"/>	<input type="checkbox"/>	<input type="checkbox"/>
			month/day			<input type="checkbox"/>	<input type="checkbox"/>	<input type="checkbox"/>	<input type="checkbox"/>			<input type="checkbox"/>	<input type="checkbox"/>	<input type="checkbox"/>	<input type="checkbox"/>	<input type="checkbox"/>	<input type="checkbox"/>	<input type="checkbox"/>
			month/day			<input type="checkbox"/>	<input type="checkbox"/>	<input type="checkbox"/>	<input type="checkbox"/>			<input type="checkbox"/>	<input type="checkbox"/>	<input type="checkbox"/>	<input type="checkbox"/>	<input type="checkbox"/>	<input type="checkbox"/>	<input type="checkbox"/>
			month/day			<input type="checkbox"/>	<input type="checkbox"/>	<input type="checkbox"/>	<input type="checkbox"/>			<input type="checkbox"/>	<input type="checkbox"/>	<input type="checkbox"/>	<input type="checkbox"/>	<input type="checkbox"/>	<input type="checkbox"/>	<input type="checkbox"/>
			month/day			<input type="checkbox"/>	<input type="checkbox"/>	<input type="checkbox"/>	<input type="checkbox"/>			<input type="checkbox"/>	<input type="checkbox"/>	<input type="checkbox"/>	<input type="checkbox"/>	<input type="checkbox"/>	<input type="checkbox"/>	<input type="checkbox"/>
			month/day			<input type="checkbox"/>	<input type="checkbox"/>	<input type="checkbox"/>	<input type="checkbox"/>			<input type="checkbox"/>	<input type="checkbox"/>	<input type="checkbox"/>	<input type="checkbox"/>	<input type="checkbox"/>	<input type="checkbox"/>	<input type="checkbox"/>
			month/day			<input type="checkbox"/>	<input type="checkbox"/>	<input type="checkbox"/>	<input type="checkbox"/>			<input type="checkbox"/>	<input type="checkbox"/>	<input type="checkbox"/>	<input type="checkbox"/>	<input type="checkbox"/>	<input type="checkbox"/>	<input type="checkbox"/>
			month/day			<input type="checkbox"/>	<input type="checkbox"/>	<input type="checkbox"/>	<input type="checkbox"/>			<input type="checkbox"/>	<input type="checkbox"/>	<input type="checkbox"/>	<input type="checkbox"/>	<input type="checkbox"/>	<input type="checkbox"/>	<input type="checkbox"/>
			month/day			<input type="checkbox"/>	<input type="checkbox"/>	<input type="checkbox"/>	<input type="checkbox"/>			<input type="checkbox"/>	<input type="checkbox"/>	<input type="checkbox"/>	<input type="checkbox"/>	<input type="checkbox"/>	<input type="checkbox"/>	<input type="checkbox"/>
			month/day			<input type="checkbox"/>	<input type="checkbox"/>	<input type="checkbox"/>	<input type="checkbox"/>			<input type="checkbox"/>	<input type="checkbox"/>	<input type="checkbox"/>	<input type="checkbox"/>	<input type="checkbox"/>	<input type="checkbox"/>	<input type="checkbox"/>
			month/day			<input type="checkbox"/>	<input type="checkbox"/>	<input type="checkbox"/>	<input type="checkbox"/>			<input type="checkbox"/>	<input type="checkbox"/>	<input type="checkbox"/>	<input type="checkbox"/>	<input type="checkbox"/>	<input type="checkbox"/>	<input type="checkbox"/>
			month/day			<input type="checkbox"/>	<input type="checkbox"/>	<input type="checkbox"/>	<input type="checkbox"/>			<input type="checkbox"/>	<input type="checkbox"/>	<input type="checkbox"/>	<input type="checkbox"/>	<input type="checkbox"/>	<input type="checkbox"/>	<input type="checkbox"/>
			month/day			<input type="checkbox"/>	<input type="checkbox"/>	<input type="checkbox"/>	<input type="checkbox"/>			<input type="checkbox"/>	<input type="checkbox"/>	<input type="checkbox"/>	<input type="checkbox"/>	<input type="checkbox"/>	<input type="checkbox"/>	<input type="checkbox"/>
			month/day			<input type="checkbox"/>	<input type="checkbox"/>	<input type="checkbox"/>	<input type="checkbox"/>			<input type="checkbox"/>	<input type="checkbox"/>	<input type="checkbox"/>	<input type="checkbox"/>	<input type="checkbox"/>	<input type="checkbox"/>	<input type="checkbox"/>
			month/day			<input type="checkbox"/>	<input type="checkbox"/>	<input type="checkbox"/>	<input type="checkbox"/>			<input type="checkbox"/>	<input type="checkbox"/>	<input type="checkbox"/>	<input type="checkbox"/>	<input type="checkbox"/>	<input type="checkbox"/>	<input type="checkbox"/>
			month/day			<input type="checkbox"/>	<input type="checkbox"/>	<input type="checkbox"/>	<input type="checkbox"/>			<input type="checkbox"/>	<input type="checkbox"/>	<input type="checkbox"/>	<input type="checkbox"/>	<input type="checkbox"/>	<input type="checkbox"/>	<input type="checkbox"/>
			month/day			<input type="checkbox"/>	<input type="checkbox"/>	<input type="checkbox"/>	<input type="checkbox"/>			<input type="checkbox"/>	<input type="checkbox"/>	<input type="checkbox"/>	<input type="checkbox"/>	<input type="checkbox"/>	<input type="checkbox"/>	<input type="checkbox"/>
			month/day			<input type="checkbox"/>	<input type="checkbox"/>	<input type="checkbox"/>	<input type="checkbox"/>			<input type="checkbox"/>	<input type="checkbox"/>	<input type="checkbox"/>	<input type="checkbox"/>	<input type="checkbox"/>	<input type="checkbox"/>	<input type="checkbox"/>
			month/day			<input type="checkbox"/>	<input type="checkbox"/>	<input type="checkbox"/>	<input type="checkbox"/>			<input type="checkbox"/>	<input type="checkbox"/>	<input type="checkbox"/>	<input type="checkbox"/>	<input type="checkbox"/>	<input type="checkbox"/>	<input type="checkbox"/>
			month/day			<input type="checkbox"/>	<input type="checkbox"/>	<input type="checkbox"/>	<input type="checkbox"/>			<input type="checkbox"/>	<input type="checkbox"/>	<input type="checkbox"/>	<input type="checkbox"/>	<input type="checkbox"/>	<input type="checkbox"/>	<input type="checkbox"/>
			month/day															

# Recordkeeping

- Under reporting
- OSHA form 300
  - F. injury or illness, body part affected and object /substance that caused instance
  - K. Days away from work
  - L. Days of on the job transfer or restriction
- 7 days to record on log

# OSHA 300A Form

OSHA's Form 300A

## Summary of Work-Related Injuries and Illnesses

Year 20\_\_



U.S. Department of Labor  
Occupational Safety and Health Administration

Form approved OMB no. 1218-0

All establishments covered by Part 1904 must complete this Summary page, even if no work-related injuries or illnesses occurred during the year. Remember to review the Log to verify that the entries are complete and accurate before completing this summary.

Using the Log, count the individual entries you made for each category. Then write the totals below, making sure you've added the entries from every page of the Log. If you had no cases, write "0."

Employees, former employees, and their representatives have the right to review the OSHA Form 300 in its entirety. They also have limited access to the OSHA Form 301 or its equivalent. See 29 CFR Part 1904.35, in OSHA's recordkeeping rule, for further details on the access provisions for these forms.

### Number of Cases

Total number of deaths	Total number of cases with days away from work	Total number of cases with job transfer or restriction	Total number of other recordable cases
_____	_____	_____	_____
(G)	(H)	(I)	(J)

### Number of Days

Total number of days of job transfer or restriction	Total number of days away from work
_____	_____
(K)	(L)

### Injury and Illness Types

Total number of . . .	(M)
1) Injuries	_____
2) Musculoskeletal disorders	_____
3) Skin disorders	_____
(4) Respiratory conditions	_____
(5) Poisonings	_____
(6) Hearing loss cases	_____
(7) All other illnesses	_____

### Establishment Information

Your establishment name \_\_\_\_\_

Street \_\_\_\_\_

City \_\_\_\_\_ State \_\_\_\_\_ ZIP \_\_\_\_\_

Industry description (e.g., *Manufacture of motor truck trailers*) \_\_\_\_\_

Standard Industrial Classification (SIC), if known (e.g., *SIC 3715*) \_\_\_\_\_

**Employment Information** (If you don't have these figures, see the Worksheet on the back of this page to estimate.)

Annual average number of employees \_\_\_\_\_

Total hours worked by all employees last year \_\_\_\_\_

### Sign here

Knowingly falsifying this document may result in a fine.

I certify that I have examined this document and that to the best of my knowledge the entries are true, accurate, and complete.

Company executive \_\_\_\_\_ Title \_\_\_\_\_

(\_\_\_\_\_) / / \_\_\_\_\_  
Phone Date

Post this Summary page from February 1 to April 30 of the year following the year covered by the form.

Public reporting burden for this collection of information is estimated to average 30 minutes per response, including time to review the instructions, search existing data sources, gather the data needed, and

# Hazard Communication

# Scope

- Covers chemicals "known to be present" in the workplace
- This includes chemicals to which employees may be exposed to during normal operations or in a foreseeable emergency.

# *Consumer Products*

- defined as such under the CP Safety Act
- used as intended by the manufacturer
- used with the same frequency and duration of a typical consumer.
  
- windshield wiper fluid – methanol
  - sprayed onto the windshield for cleaning
  - An employee using windshield-wiper fluid on a daily basis to clean glass would be covered by the standard
  - the frequency and duration of exposure is greater than a normal consumer

# Written hazard communication program

- **Responsibility** and management of the program.
- Development of a **list** for tracking hazardous chemicals
- Method for **labeling** hazardous chemicals.
- Management of **Material Safety Data Sheets**.
- Procedures for **training** exposed employees.
- Method to address the hazards of **non-routine tasks**.
- Procedures for **Multi-employer** workplaces.



# How must chemicals be labeled?

- Chemical identity
- Appropriate hazard warnings
- Name and address of the responsible party

# The one, one, one rule.

- When a hazardous chemical is transferred into **one** container for the immediate use (**one** shift) by **one** employee, then the container does not have to be labeled.
- Any residual in the container must be immediately recycled or treated as waste.
- Most common excuse.



# Material Safety Data Sheets

- Clearly convey reliable information about hazardous chemicals
- 1987

# Material Safety Data Sheet (MSDS)

- Accessible during each work shift.
- Electronic access, microfiche, and alternatives to paper are permitted as long as barriers to access are not created.
- Must be in English



# Hazard Communication Training

- At the time of initial assignment
- Whenever a new hazard is introduced in the work area

# Employee information

- The requirements of the standard.
- Operations in their work area where hazardous chemicals are present.
- The location and availability of the written program, hazardous chemical list, and material safety data sheets.

# Employee training

- Methods and observations used to detect a release of a hazardous chemical (monitoring, odor, visual appearance)
- The physical and health hazards of chemicals in the work area.
- The measures employees can take to protect themselves (specific procedures, work practices, emergency procedures, and ppe)
- The details of the hazard communication program (labeling, MSDS's, and how to obtain and use the information.

# Globally Harmonized System of Classification and Labeling of Chemicals

Uniformity-Oriented

# Why a Globally Harmonized System?



- The GHS intent is to provide a single system to classify chemicals, labels and safety data sheets and increase the quality and consistency of information provided to workers, employers and chemical users.
- GHS labels include signal words, pictograms, and hazard and precautionary statements.
- Safety data sheets would be presented in a designated order.

# Labels on shipped containers

- Product Identifier – what it is
- Signal word – severity of hazard alert
  - Danger / Warning
- Hazard Statement – words assigned to hazard class
- Pictograms
- Precautionary Statement – recommended measures to minimize effects

# Pictograms...

Figure C.1 – Hazard Symbols and Classes

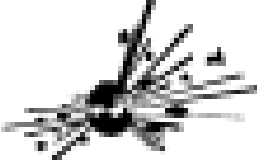
Flame	Flame Over Circle	Exclamation Mark	Exploding Bomb
 <p>Flammables</p> <p>Self Reactives</p> <p>Pyrophorics</p> <p>Self-heating</p> <p>Emits Flammable Gas</p> <p>Organic Peroxides</p>	 <p>Oxidizers</p>	 <p>Irritant</p> <p>Dermal Sensitizer</p> <p>Acute Toxicity (harmful)</p> <p>Narcotic Effects</p> <p>Respiratory Tract Irritation</p>	 <p>Explosives</p> <p>Self Reactives</p> <p>Organic Peroxides</p>

# Pictograms...

Corrosion



Corrosives

Gas Cylinder



Gases Under Pressure

Health Hazard

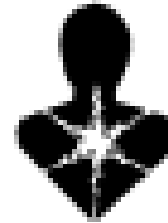

Carcinogen

Respiratory Sensitizer

Reproductive Toxicity

Target Organ Toxicity

Mutagenicity

Aspiration Toxicity

Skull and Crossbones



Acute Toxicity (severe)



# Safety data sheets

- 1. Identification
- 2. Hazard(s) Identification
- 3. Composition/information on ingredients
- 4. First-aid measures
- 5. Firefighting measures
- 6. Accidental release measures
- 7. Handling and storage
- 8. Exposure controls / ppe



# Safety data sheets

- 9. Physical and chemical properties
- 10. Stability and reactivity
- 11. Toxicological information
- 12. Ecological information
- 13. Disposal Considerations
- 14. Transport information
- 15. Regulatory information
- 16. Other information

# PPE hazard assessment

- Assessment of all jobs/tasks.
- Written certification.
- Certifying official identified.
- Date of last evaluation

# Personal Protective Equipment

- Eye and face protection
- Respiratory protection
- Head protection
- Foot protection
- Hand protection
- High visibility equipment
- Electrical protective equipment



# *Welding on stainless steel*

- Stick welding: High likelihood of overexposure to Cr VI
  - 50% of total Cr produced is Cr VI (FR pg 10262 col 3)
- TIG generates lower fume amounts
- Submerged arc generates lower fume amounts
- MIG has lower fume amounts
  - 4% of total Cr produced from MIG is Cr VI
- MIG and TIG
  - @ 800 degrees C *above action level*
  - @ 500 degrees C levels fairly low
- Conclusion: Switch from stick to MIG if possible

# Respiratory Protection Program

- Program Administrator
- Written program – selection process
  - Do you know the level of the contaminant?
- Medical evaluation
- Fit test
- Training
- Recordkeeping

# Testing conditions in the confined space

- Determine if acceptable entry conditions exist before entry
- Test in the following order:
  - Oxygen - some monitors will not function without adequate oxygen
  - Combustible gases and vapors – fire hazard is immediate
  - Toxic gases and vapors.
- Do not enter to complete tests.

# Rescue

- Each member shall practice simulated rescue operations every 12 months from representative spaces.
- Must be trained in CPR and first aid.
- Entrants shall use a full body harness to facilitate rescue.
- Evaluation of rescue service.

# Rescue and emergency services

- Evaluate rescuer's ability to respond in a timely manner.
- Evaluate rescue service's
  - ability
  - proficiency with rescue-related tasks and equipment
  - function from the particular permit space types of spaces

# 1910.272(g)(1)(ii)

- All mechanical, electrical, hydraulic, and pneumatic equipment which presents a danger to employees inside grain storage structures shall be deenergized and shall be disconnected, locked-out and tagged, blocked-off, or otherwise prevented from operating by other equally effective means or methods.

# Lockout / tagout

- Applies to the maintenance and service of machines and equipment in which the unexpected start up or release of stored energy could cause injury.
- Applies to production operations when the employee...
  - removes or bypasses a guard or safety device.
  - places any part of his body into an area where a danger zone exists.

# Servicing and Maintenance

“Exposure to unexpected energy”

- Constructing, installing, setting up, adjusting, inspecting, and modifying equipment.
- Lubrication
- Cleaning
- Unjamming
- Adjustments
- Tool changes
- Establishes minimum performance requirements

# Machine specific procedures

- Location
  - Switch number one on electrical panel #302
- Method
  - Circuit breaker device and personal lock
- Verification
  - Push main green start button on equipment, look for lights or movement

Verify

This is the test



# Periodic Inspection

- Conducted annually
- Ensure procedures are properly implemented

# Employee Training

- Recognition of energy sources.
- Type and magnitude of energy.
- Method and means for isolation.

# Retraining

- If there are changes in job assignments, machines, process, or a new hazard.
- Inadequacies in the employee's knowledge of the control procedures.
- The retraining shall establish employee proficiency.

# *Who here has worked on or near live electrical?*

- Hazard: arc flash, arc blast & shock
- Work performed on or near energized circuits
  - Testing, troubleshooting, measuring voltage
- Conduct a flash hazard analysis
  - Ensure use of proper electrical protective equipment in compliance with NFPA 70e
- Establish a flash protection boundary

# Powered Industrial vehicles

- Inspection prior to use
- Removed from service
- Training on type
- Evaluation

# OSHA Citations

## Citation 1 Item 1a Type of Violation: **Serious**

29 CFR 1910.23(c)(1): Open sided floor(s) or platforms(s) 4 feet or more above the adjacent floor or ground level were not guarded by standard railings [or the equivalent as specified in 29 CFR 1910.23(e)(3)(i) through (v)], on all open sides:

Company exposed employees to fall hazards without fall protection of approximately 14 ft., 8 in., while opening and closing lids from the tops of rail cars at the facility on Lines #2 - #5. The employer did not ensure the work area was guarded by a standard railing or equivalent method.

## Citation 1 Item 1b Type of Violation: **Serious**

29 CFR 1910.132(d)(1)(i): When the employer had assessed the workplace hazard(s) and determined that hazard(s) were present, the employer did not select and/or use the types of personal protective equipment that would protect the affected employee from the hazard(s) identified:

exposed employees to fall hazards without fall protection approximately 14 ft., 8 in., while opening and closing lids from the tops of rail cars at the facility. On May 15, 2007, an employee fell from rail car on Line #1, while closing a lid due to an incoming storm.

# Amputation hazards

- 1910.212 – General requirements for all machines
- 1910.213 – Woodworking machinery requirements
- 1910.214 – Cooperage machinery (wood barrels)
- 1910.215 – Abrasive wheel machinery
- 1910.216 – Mills and Calendars
- 1910.217 – Mechanical Power presses
- 1910.218 – Forging machines
- 1910.219 – Mechanical power-transmission

# No Grand fathering

- Original equipment manufactures have to warn of the hazards.

# Fan blades

- Fan guard openings less than 1/2 inch.

# Housekeeping program

- **establish the frequency and method to reduce accumulations of fugitive grain dust on ledges, floors, equipment, and other exposed surfaces**
- Immediately remove any fugitive grain dust accumulations whenever they exceed 1/8 inch (.32 cm) at priority housekeeping areas
  - within 35 feet (10.7 m) of inside bucket elevators
  - Floors areas containing grinding equipment
  - Areas containing grain dryers inside the facility

# Where do explosions occur?

- **Bucket elevators**
- **Roller mills**
- **Storage bins or tanks**
- **Headhouse**
- **Dust collector**

# Dust Explosion Preventive Measures

- **Minimize dust accumulation**
- **Use spark proof electrical equipment**
- **Reduce overheating of machinery**
  - \* provide proper maintenance to equipment
    - ▶ bearings
    - ▶ belts
    - ▶ conveyors

# Ground-fault circuit interrupters

- **1926.404(b)(1)(ii)** All 120-volt, single-phase 15- and 20-ampere receptacle outlets on construction sites, which are not a part of the permanent wiring of the building or structure and which are in use by employees, shall have approved ground-fault circuit interrupters for personnel protection.

- Brian Bothast
- Compliance Assistance Specialist
  - Peoria Area Office
  - T 309.589.7033
- [bothast.brian@dol.gov](mailto:bothast.brian@dol.gov)